

TYPICAL PERFORMANCE CHARACTERISTICS

Standard Test Conditions: +25°C, RF (LO) Input = +15 dBm, RF Input = 0 dBm @ LO+30 MHz.

Conversion Loss

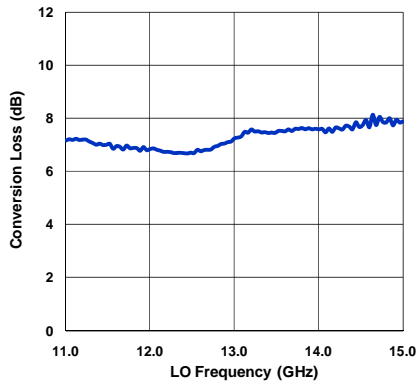

LO Leakage

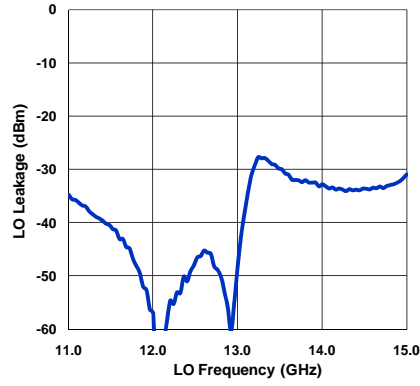

Sideband Suppression

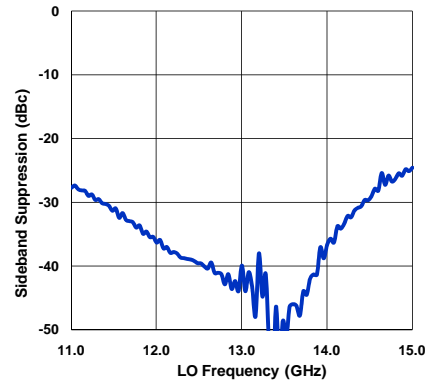

DIMENSION DRAWING

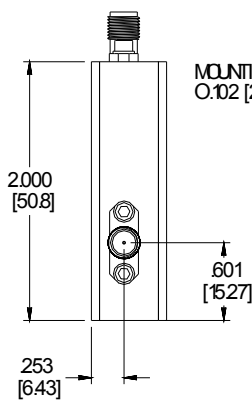
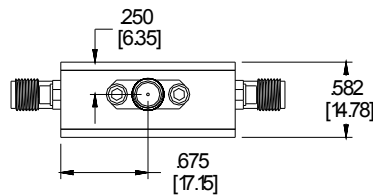
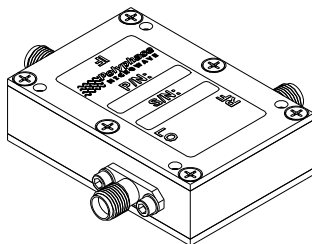

MOUNTING HOLES
0.102 [2.59] THRU 4 PLACES

